

Loppuseminaari

Plug & Play WP3 (Drivers, Barriers and Markets)

Tiistai 26.5.2009, klo 9.00–12.00

Innopoli 1, Tekniikantie 12, Espoo (Leonardo-sali)

Background

This feasibility study proposes extension of the successful industrialisation of building components to building a complete house from components. The aim is to transform the intelligence, competences and skills of the construction process into intelligently designed components of the self assembly kind, just as IKEA did with furniture. The projects technical focus is on a USB inspired interface between physical building components. An open source physical standard interface makes it possible to assemble components from different industries. And to disassemble components, moving them and reassembling them differently just like a LEGO building. Similar to the real hardware components, related engineering software components shall be plugged together in order to build simulation and assessment models. This will be the first ever attempt to fully industrialise maintenance, remodelling and reconstruction of building, a sector of the same magnitude as the new buildings sector.

Workpackages of whole project:

- Breaking any architecture down in modular adaptable architecture (both for hardware as well as for related engineering software).
- Research in a USB inspired open source standard interface optimised for consumer co-construction and co-design
- Gather and process information of the Drivers, Barriers and markets for Plug & Play house.
- Development of a kind of DELL business model for building construction
- Methodologies for an automated cost & performance assessment of configurable buildings
- User centred innovation visualising the concepts in 3D

Lisätiedot:

Esa Nykänen, VTT
puh 020 722 6914
Esa.Nykanen@vtt.fi

Ilmoittautumiset 20.5.2009 mennessä

Christina.Vahavaara@vtt.fi

(Mainitse viestissä tilaisuuden nimi, Plug & Play -loppuseminaari)

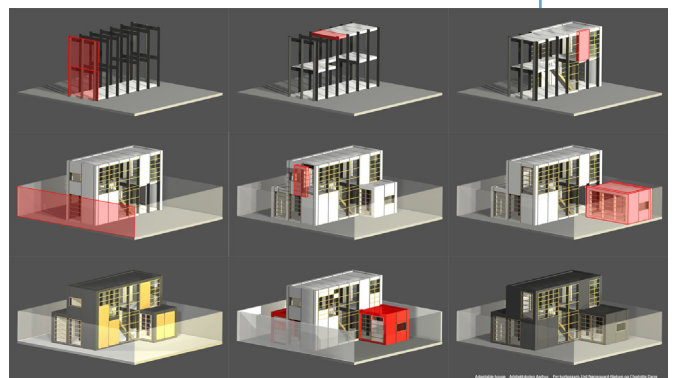

OHJELMA

9:00 – 9:30	Ilmoittautuminen ja kahvi
9:30 – 9:35	Tilaisuuden avaus
9:35 – 9:45	Projektiesittely <i>Esa Nykänen, VTT</i>
9:45 – 10:10	Architecture dream with plug and play <i>Ivar Moltke, DTI (in english)</i>
10:10 – 10:30	Strategic Roadmapping & Action Planning, <i>Abdul Samad (Sami) Kazi, VTT (in english)</i>
10:30 – 10:50	Drivers, Barriers, Business Model for P & P, <i>Esa Nykänen, VTT</i>
10:50 – 11:10	Case Paroc <i>Dick Karlsson, Paroc Panels</i>
11:10 – 11:40	P & P Markets in Sweden <i>Ronny Andersson, Visiting Professor, Lund University (in english)</i>
11:40 – 11:55	EcoDrive projekti ("Plug & Play korjaus-rakentamisessa"), <i>Jyri Nieminen, VTT</i>
11:55 – 12:00	Keskustelua , tilaisuuden päätös

plugandplay.vtt.fi/

Seminaaripaikka karttalinkkinä